

5% DEPOSIT
BALANCE
ON COMPLETION



CAPRI MK2 - MID

\$419,900*

\$399,900* FIRST HOME BUYERS

3 2.5 2

Turnkey - Essential Specification*

Site Costs included

Concrete paving

1.8m fencing to side boundaries+

Landscaping to front and rear+

Clothesline (Hills wall mounted)

Rendered letterbox

Ducted heating

Timber look flooring to living rooms

Carpet to bedrooms

2550mm ceilings to living area

Stainless steel oven and cooktop

+ Landscaping and fencing to be completed at handover.

* Items to be selected from Essentials specifications.

Speak to your New Home Advisor for a full list of standard inclusions.

Available Lots: 1226,1227,1228 & 1229

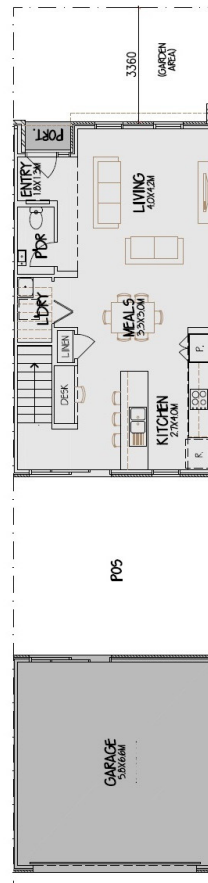

GROUND FLOOR PLAN

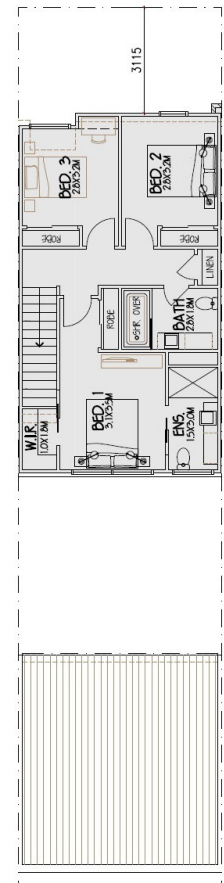

FIRST FLOOR PLAN